

**CLOCK OUT WALL SOCKETS FOR PICTURE LIGHTS**

The standard mains power connection point for a picture light usually takes the form of special recessed two-part socket + integrated fused plug assembly.

This is installed and wired into like any electrical socket, being located on the wall behind where a painting is to be hung. Incoming mains power is wired as standard into the wall socket receptor; the wires for the picture light itself are wired into the 'plug' element at the time the picture light itself is installed.

Because the socket + plug assembly is designed to finish flush, this type of power point does not protrude from the surface of the wall in a manner that would obstruct the hang of the painting by pushing it out.

This type of special two-part electrical connection device is typically known as a Clock Out Socket, or a Clock Point.

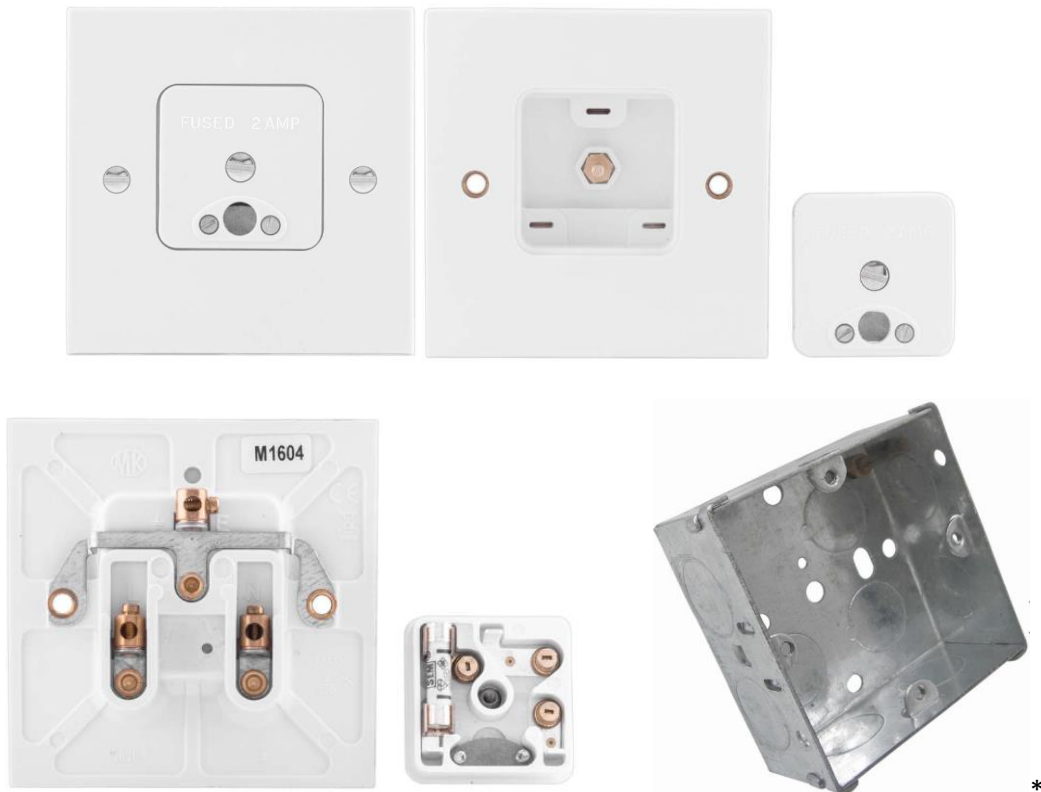

**SPECIFICATION**

**GENERAL**

COLOUR                                      White  
 CONSTRUCTION                            Aluminium

**DIMENSIONS**

DEPTH                                        28mm  
 HEIGHT X WIDTH                        85mm x 85mm  
 PLATE DEPTH                              4.2mm

- Single plate metal back box with special 47mm depth also required, as per standard shaving socket